

## Hundai HD75 – Mobile Laboratory

### Laboratory Dimensions:

4.5 Meter X 2.14 Meter  
Inside Height : 2.05 Meter

### **Material : Polyester**

Side thickness : 30 mm  
Roof thickness : 60 mm  
Floor thickness : 90 mm

### **Right Side:**

Door  
French sliding Windows  
500 mm Height X 800 mm Width

### **Left Side:**

Door  
French sliding Windows  
500 mm Height X 800 mm Width

### **Rear:**

Door (70 cm width) including window  
2 steps ladder

### **Outside:**

Air deflector on top of front cabin  
Rectactable rain shelter on the right side

The structure is divided into 2 section  
Length of each section 2200 mm (+/-)  
Door between 2 sections

The Mobile laboratory being made of 2 rooms, closer room from Truck cabin is called "1<sup>st</sup> room" and rear room is called "2<sup>nd</sup> room"

The Mobile laboratory is aimed to receive patients to be checked with viruses (Aids for example)  
1<sup>st</sup> room is for welcoming of patients (explaining to them how Aids contamination happens and to inform patients how to prevent Aids contamination)  
2<sup>nd</sup> room is for checking patients health condition, including examination on table.

### 1/ 1<sup>st</sup> room:

#### Equipments :

- Desk with 2 folding chairs (1 on each side of the desk), for welcoming patients and discussion with them  
→ Desk includes 1 draw for sorting documents
- Furniture for storage of little materials installed on top of Desk (higher part of room)
- Examination bed (covered in "medical leather imitation" fabric) built on top of a piece of furniture (with draws, so it will be possible to store little materials in it)
- Vertical blind to cover windows, from inside (made of horizontal blades)
- 2 x 220V electrical switches near desk
- 1 x 220V electrical switch near examination bed
- 2 hooks installed on wall (or behind door) for clothes hanging
- Lighting of room from 1 fluorescent light (long model), installed on roof/ceiling of room



## 2/ 2<sup>nd</sup> room:

### Equipments :

- 1 Fridge
- Storage Furniture installed on the floor (lower part of room)  
→ This furniture will also include the fridge
- Examination bed (covered in "medical leather imitation" fabric) built on top of a piece of furniture (with draws, so it will be possible to store little materials in it)
- Storage Furniture installed on the floor (lower part of room)  
→ This furniture will include on its top the water sink (equipped with small electrical water pump) and the 80 liters tank
- Furniture for storage of little materials installed on top of Sink (higher part of room)
- Soap displayer installed near sink
- Vertical blind to cover windows, from inside (made of horizontal blades)
- 3 x 220V electrical switches near examination bed
- 2 x 220V electrical switch near water sink
- 2 hooks installed on wall (or behind door) for clothes hanging
- Lighting of room from 1 fluorescent light (long model), installed on roof/ceiling of room

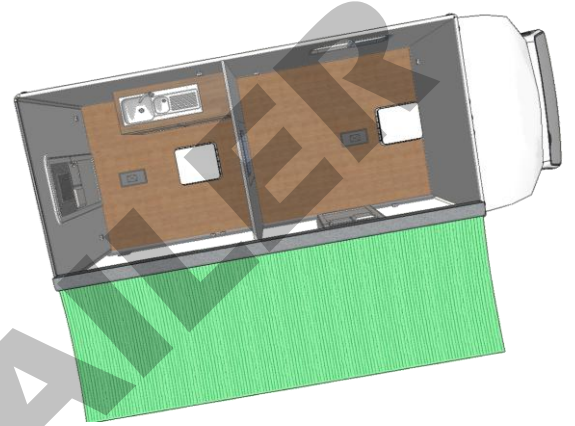

## 3/ Additional equipment :

- Second electrical battery with load balancer
- Converter from battery 12V to 220V / 2000 Watt (in order to supply electrical power for the following :
  - Fridge
  - Lighting of both rooms
  - Electrical water pump
  - Electrical switches
- External 220V electrical switch
- Electrical cables are to be covered by "raceway"
- Electricity control panel with circuit-breaker
- Air-conditioning unit with 2 outputs (1 for each room)
- 1 fire extinguisher of 2 kgs

